



Kansans **CAN**

# Kindergarten Readiness in Kansas



# The State Board's Vision



Kindergarten readiness is an important building block for a student's future achievement and success

Data will support data-driven decision making by schools, districts and state policy makers

Consider targeted ways to increase kindergarten readiness

# Kansas' Current Landscape in Getting Kids Ready for Kindergarten

## Programs:

- 4 Year-Old At Risk, Kansas Preschool Program, Parents as Teachers, Early Childhood Special Education

## Cross Agency Work:

- Children's Cabinet and Trust Fund, Department of Children and Families, Department of Health and Environment

# Kindergarten Readiness Workgroup



**Monica Blosser**, Early Childhood Director, Children's Cabinet and Trust Fund

**\*Barbara Dayal**, Preschool and Special Education, KSDE

**Julie Ewing**, English Learners & Title III, KSDE

**Emily Fleming**, KCK ECC Assistant Principal, KCK Public Schools

**Beth Fultz**, Career Standards and Assessments, KSDE

**Tracie Kalic**, Migrant Education GOSOSY Director

**Kim Kennedy**, Head Start Collaboration Office, DCF

**Barbara Kramer**, Part C Program Analyst, KDHE

**Richard Matteson**, Requirements Analyst, KSDE

**Shawna McAllister**, Kindergarten Teacher, Canton-Galva Elementary

**Tammy Mitchell**, Kindergarten Readiness & School Improvement, KSDE

**Monica Murnan**, Director of Student Support Services, Greenbush

**Tony Moss**, Research and Evaluation, KSDE

**Chelie Nelson**, Kansas MTSS

**\*Janet Newton**, Parents as Teachers, KSDE

**\*Vera Stroup-Rentier**, Early Childhood, Special Education, and Title, KSDE, Chair

# Kansas' Current Landscape

## Getting Children Ready for Kindergarten



### Where are the four-year-olds?

- ✓ Kansas Preschool Program
- ✓ State Pre-K
- ✓ Kansas Parents as Teachers
- ✓ Head Start Programs
- ✓ Child Development Centers
- ✓ Faith-Based Preschools
- ✓ Early Childhood Special Education Programs
- ✓ Child Care Providers
- ✓ At Home

# Questions Considered



- What are districts currently using?
- What are other states using?
- Do we want to build our own?
- What information do we want to collect?

# Key Ideas: Kindergarten Readiness

Measuring kindergarten readiness provides a snapshot of where children are upon entry to kindergarten.

Kindergarten readiness screening will include communication (language & literacy), problem solving, motor, and social emotional areas of development.

Families and caregivers will be engaged in gathering information about their child's development and early childhood experiences prior to kindergarten.

# A Kindergarten Readiness Screener



## A Hinge – Not a Gate

- Swings back to inform regarding prior experiences
- Swings forward to inform effective classroom practices

Informs districts regarding their communities capacity for early childhood

**Not a gate keeper to “screen” five year olds out of Kindergarten**

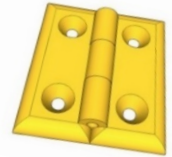



# A Screener is Not a Test

## Screening Tool

## Assessment/Test

**Looks at developmental milestones**

**Looks at skills acquired**

**Provides a snapshot**

**Is more comprehensive**

**Brief to administer**

**Administration can be lengthy**

**Largely observational in nature**

**Requires individual testing**

# Ages and Stages Questionnaires



**ASQ-3**  
Ages & Stages  
Questionnaires<sup>®</sup>  
THIRD EDITION

**Ages & Stages Questionnaires, Third Edition (ASQ-3™)**  
A Parent-Completed Child Monitoring System  
By Jane Squires, Ph.D., & Diane Bricker, Ph.D.

**ASQ-3™  
AT A GLANCE**

Type of screening	Developmental screening
Areas screened	Communication, Gross Motor, Fine Motor, Problem Solving, and Personal-Social
Age range	1-66 months

ASQ-3  
Ages & Stages  
Questionnaires<sup>®</sup>  
THIRD EDITION

Ages & Stages  
Questionnaires<sup>®</sup>  
A Parent-Completed  
Child Monitoring System  
THIRD EDITION  
Jane Squires & Diane Bricker

ASQ-3  
User's Guide

Jane Squires,  
Diane Bricker,  
& Linda Price

# Considerations



- Used during regular home and/or classroom activities
- Based on families'/teachers' observations of children's skills and abilities
- Addresses communication, motor, problem solving, personal and social-emotional skills
- Aligns with tools already used in early childhood settings



# Fall 2016 Pilot Participants



Prairie Hills  
Cherokee  
Southern Lyon County  
Emporia  
Humboldt  
Derby  
Maize  
Plainville  
Elk Valley  
Lincoln  
Salina  
Nickerson  
Hoisington  
Dodge City  
Winfield  
Geary County  
Hays  
Chetopa/St. Paul  
Satanta

Buhler  
McLouth  
Seaman  
Goodland  
Chaparral Schools  
Prairie View  
Holcomb  
Atchison County  
Vermillion  
Ellis  
Eureka  
Peabody-Burns  
Atchison  
McPherson  
Canton-Galva  
Valley Heights  
Kansas City  
Topeka  
South Haven

# Fall 2016 Pilot

<b>June 2016</b>	<b>Participants in the fall 2016 pilot will be determined</b>
<b>August 2016</b>	Small team Trainer of Trainers receive official training
<b>September 2016</b>	Every Kindergarten teacher involved in pilot will be trained by the training team
<b>September – December 2016</b>	ASQ-3 and ASQ:SE-2 will be piloted in various districts and schools across Kansas
<b>Winter 2017</b>	Pilot cohort will provide feedback to KSDE to help inform planning of a state-wide roll out of a Kindergarten Readiness screening tool RFP process for state-wide screening tool Develop training plan
<b>*Spring/Summer/Fall 2017</b>	Implement training plan
<b>*Fall 2017</b>	State-wide data collection begins
<b>*Fall 2017</b>	Approximately 37,000 Kindergarten children, their families, and teachers will collect information using the approved screening tool

# Beyond the Pilot

Spring 2017

- Survey and meet with focus group of pilot participants to collect feedback and recommendations
- Put out an RFP for a Kindergarten Readiness screening tool
- Work with the approved vendor on a training plan
- Work with KSDE on a funding plan
- Begin state-wide data collection

# Beyond the Pilot

Questions to address in the future:

- What does the data show regarding the readiness of children entering Kindergarten?
- What are the implications for communities and schools?
- What are the implications for distribution of resources?
- What are the implications for needed professional learning?

# Questions?



Tammy Mitchell  
[tmitchell@ksde.org](mailto:tmitchell@ksde.org)

Assistant Director  
ECSETS







Kansas leads the world  
in the success of each student.

# Kansans CAN

#KansansCan

KANSAS STATE DEPARTMENT OF EDUCATION [www.ksde.org](http://www.ksde.org)